

REV	DATE	REVISION DETAILS	APPD
更改号 A	日期 JAN. 02. 2020	更改内容 drawing update	审核并批准

SEE SAE J1453-1  
REVISED MAY2012

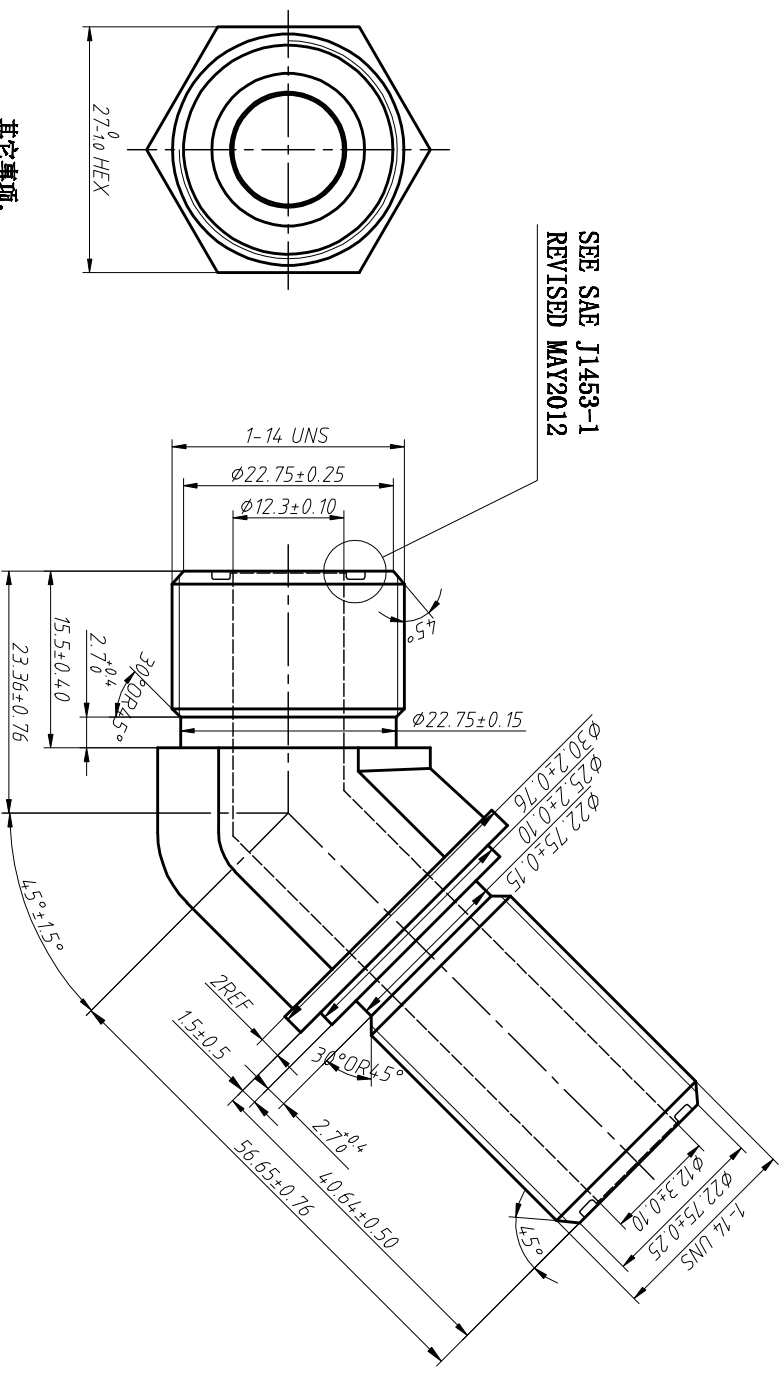

**UNLESS SPECIFIED**  
**ALL DIMENSIONS IN mm,**  
**MACHINED SURFACES Ra=3.2um,**  
**ANGLE TOLERANCES ±5°,**  
**Other tolerance except angles,**  
**in accordance with**  
**GB/T1804-2000(ISO2768-1)-m**  
**and GB/T1184-1996(ISO2768-2)-m**

**其它事项,**  
**图示尺寸单位为mm,**  
**未注机械加工表面粗糙度 Ra=3.2um,**  
**未注角度公差 ±5°,**  
**其它未注公差 (除角度外) 均按:**  
**GB/T1804-2000(ISO2768-1)-m 和**  
**GB/T1184-1996(ISO2768-2)-m**

**MATERIAL**  
Chinese steel 45

**材质** 45#

**FINISH**  
Remove all sharp edges,burrs,slivers and swarf, break all edges 0.127-0.254mm.  
ZINC PLATING WITH 8um MICRONS MINIMUM PLATING THICKNESS AND TRIVALENT CHROMATE PASSIVATION  
AND WITHSTAND 96 HRS TO WHITE / 144 HS TO RED RUST IN SALT SPRAY TEST.

去除所有毛刺, 铁屑等残留物, 破边倒角0.127-0.254mm.  
镀锌: 三价铬钝化, 银白色, 盐雾试验96小时无白锈, 144小时无红锈, 镀锌层厚度大于0um.

**Zhejiang Gaocheng Autoparts Co.,Ltd**

**PART No**  
零件名  
**2702-10FS-10FS**

<b>SCALE:</b> 批注 NTS	<b>DATE:</b> 日期	<b>DRN:</b> 制图 2020. 01. 02	<b>CHK:</b> 审核 詹永斌 2020. 01. 02
<b>APPD:</b> 批准		<b>余德胜</b>	