

REV 更改号	DATE 日期	REVISION DETAILS 更改内容	APPD 审核并批准
A	Apr.07.2020	Drawing Update	

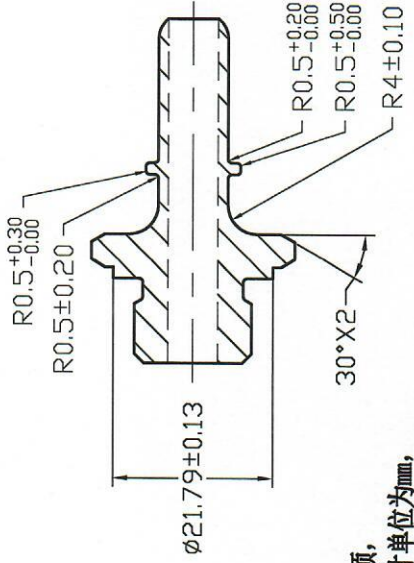
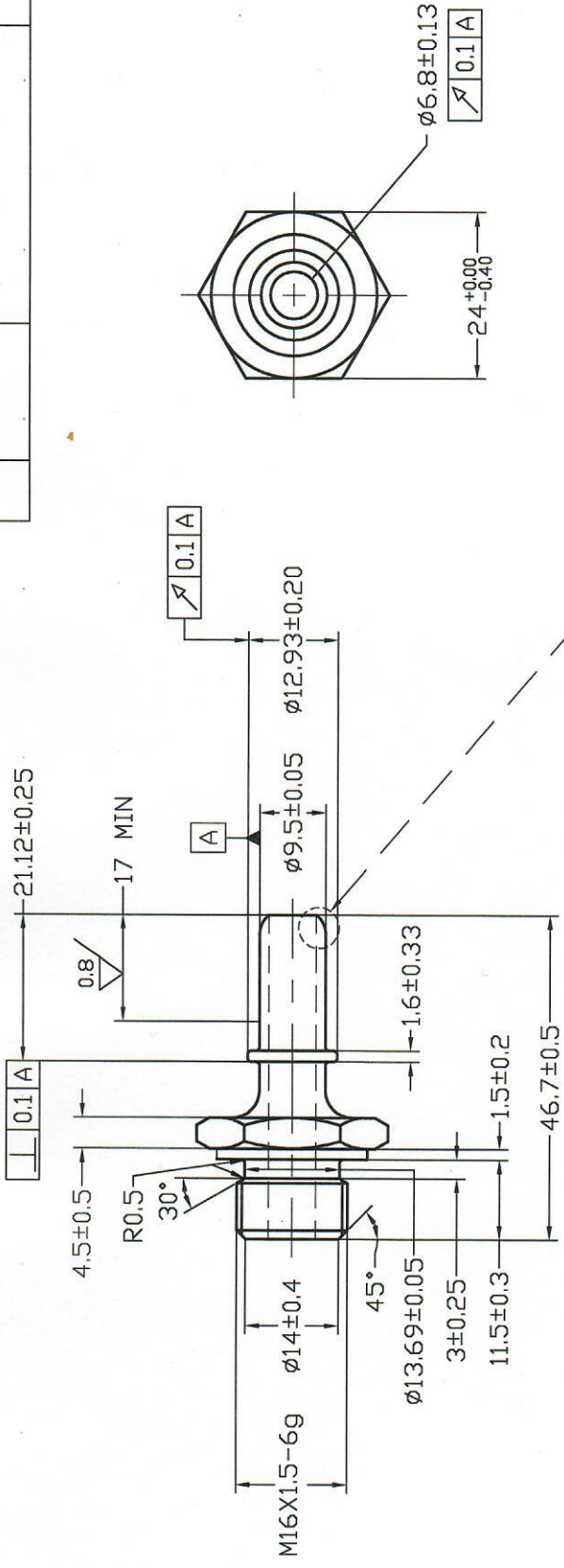

UNLESS SPECIFIED  
 ALL DIMENSIONS IN mm,  
 MACHINED SURFACES Ra=3.2um,  
 ANGLE TOLERANCES ±5°,  
 Other tolerance except angles,  
 in accordance with  
 GB/T1804-2000(ISO2768-1)-M  
 and GB/T1184-1996(ISO2768-2)-M

其它事项,  
 图示尺寸单位为mm,  
 未注机械加工表面粗糙度 Ra=3.2um,  
 未注角度公差 ±5°,  
 其它未注公差 (除角度外) 均按:  
 GB/T1804-2000(ISO2768-1)-m 和  
 GB/T1184-1996(ISO2768-2)-m

<b>Zhejiang Gaocheng Autoparts Co., Ltd</b>	
<b>PART No</b> 零件名	<b>40782-M16-9.5MM QC</b>
<b>SCALE:</b>	<b>APPD:</b> 批准
<b>NTS</b>	<b>DATE:</b> 日期
<b>MATERIAL</b>	Chinese steel 45
<b>FINISH</b>	Remove all sharp edges,burrs,silvers,rust and swarf, oil edges 0.127-0.254mm, nickel plated 去除所有毛刺, 铁屑, 锈迹等残留物, 锐边倒钝0.127-0.254mm, 表面镀镍。
	<b>DRN:</b> Sun Jianguan 制图 20.04.07
	<b>CHK:</b> Li Jumbiao 审核 20.04.07