

REV 更改号	DATE 日期	REVISION DETAILS 更改内容	APPD 审核并批准
A	Mar 20, 2020	Drawing Update	

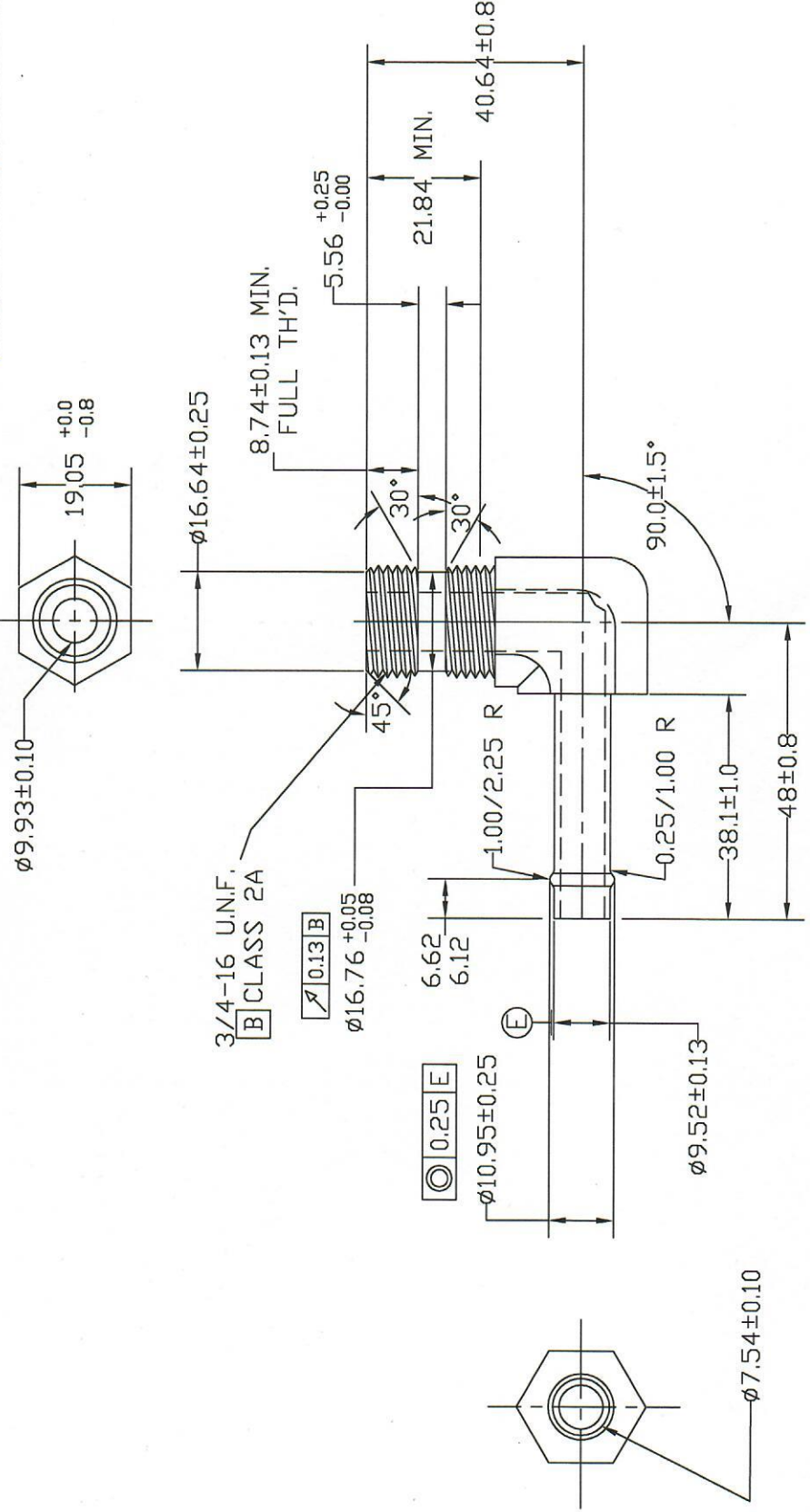

UNLESS SPECIFIED
ALL DIMENSIONS IN mm,
MACHINED SURFACES Ra=3.2um,
ANGLE TOLERANCES ±5°,
Other tolerance except angles,
in accordance with
GB/T1804-2000(ISO2768-1)-m
and GB/T1184-1996(ISO2768-2)-m

其它事项,
图示尺寸单位为mm,
未注机加工表面粗糙度 Ra=3.2um,
未注角度公差 ±5°,
其它未注公差 (除角度外) 均按:
GB/T1804-2000(ISO2768-1)-m 和
GB/T1184-1996(ISO2768-2)-m

Zhejiang Gaocheng Autoparts Co.,Ltd

PART No 零件名	4601-06-08NW□
SCALE:	
NTS	
APPD: 批准	DRN: Sun Jianghuan 制图 20.03.20
DATE: 日期	CHK: Li Junbiao 审核 20.03.20

MATERIAL Chinese steel 45

FINISH Remove all sharp edges,burrs,silvers and swarf, break all edges 0.127-0.254mm.
 ZINC PLATING WITH 8um MICRONS MINIMUM PLATING THICKNESS AND TRIVALENT CHROMATE PASSIVATION
 AND WITHSTAND 96 HRS TO WHITE / 144 HS TO RED RUST IN SALT SPRAY TEST.
 镀锌, 三价铬钝化, 银白色, 盐雾试验96小时无白点, 144小时无红锈, 镀锌厚度大于8um,
 去除所有毛刺, 钝屑等残留物, 锐边倒角0.127-0.254mm.