

REV	DATE	REVISION DETAILS	APPD
①	2020.01.07	Drawing Update	

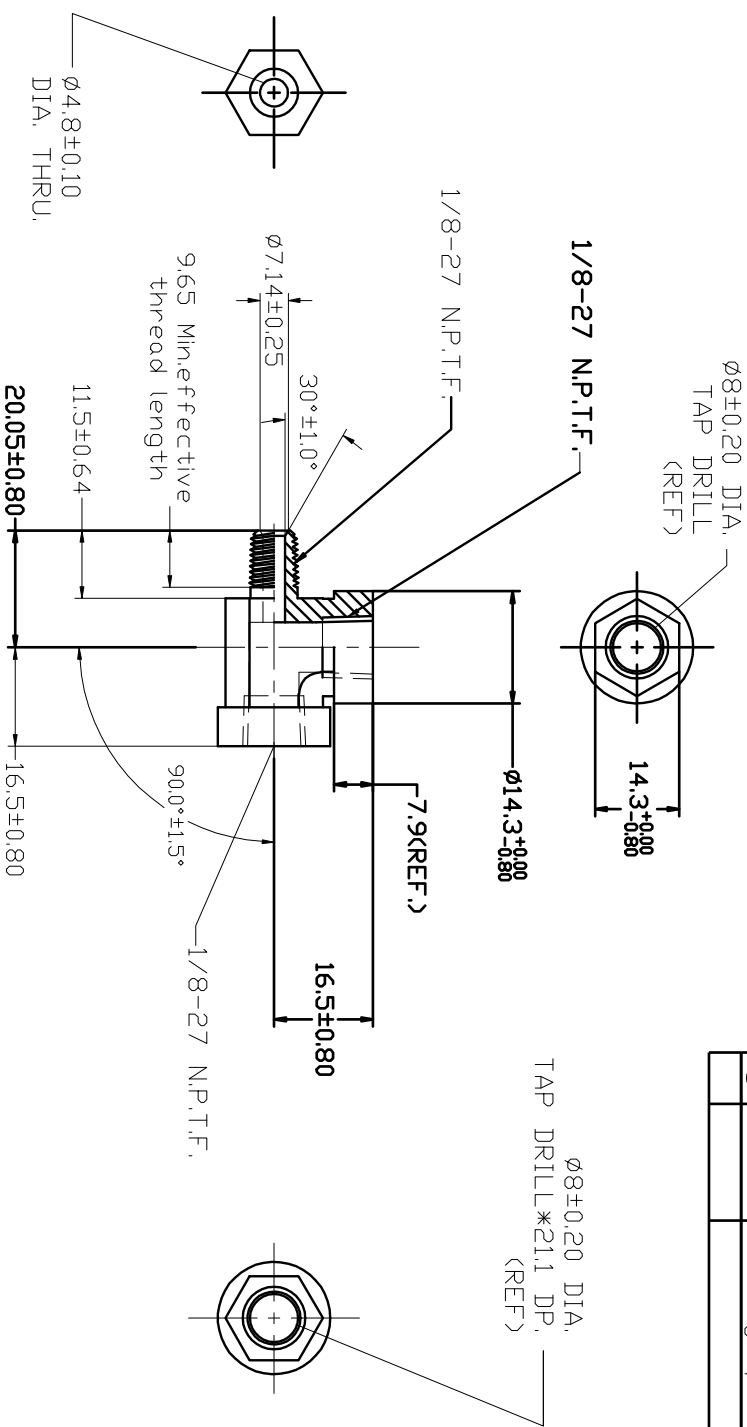

UNLESS SPECIFIED
ALL DIMENSIONS IN mm,
MACHINED SURFACES Ra=3.2um,
ANGLE TOLERANCES ±5°,
Other tolerances except angles,
in accordance with
GB/T1804-2000(ISO2768-1)m
and GB/T1804-1996(ISO2768-2)m

其它事项,
图示尺寸单位为mm,
未注加工表面粗糙度 Ra=3.2um,
未注角度公差 ±5°,
其它未注公差 (除角度外) 均按:
GB/T1804-2000(ISO2768-1)m 和
GB/T1804-1996(ISO2768-2)m

MATERIAL	Chinese steel 45		
FINISH	Remove all sharp edges and burrs, surface roughness Ra=0.127-0.254um. The chamfered end shall be chamfered at 30°±1.0°. And finishing 90° chamfer 14.3±0.00 to the end of the drill.	去除所有锐边和毛刺, 表面粗糙度 Ra=0.127-0.254um. chamfered end shall be chamfered at 30°±1.0°. And finishing 90° chamfer 14.3±0.00 to the end of the drill.	
PART No 零件名		5602-2	
SCALE: NTS		DATE: 日期	CHK: 审核
APPD: 批准		DATE: 日期	CHK: 审核
DPR: Sun Jianguan		DATE: 2020.01.07	CHK: Li Jundiao
Zhejiang Geocheng Autoparts Co., Ltd			