

REV 更改号	DATE 日期	REVISION DETAILS 更改内容	APPD 审核并批准
①	16.06.25	31 +/-0.60 changed to 31.5 +/-0.25	
②	16.06.25	18.5 +/-0.20 changed to 18.00 +/-0.20	

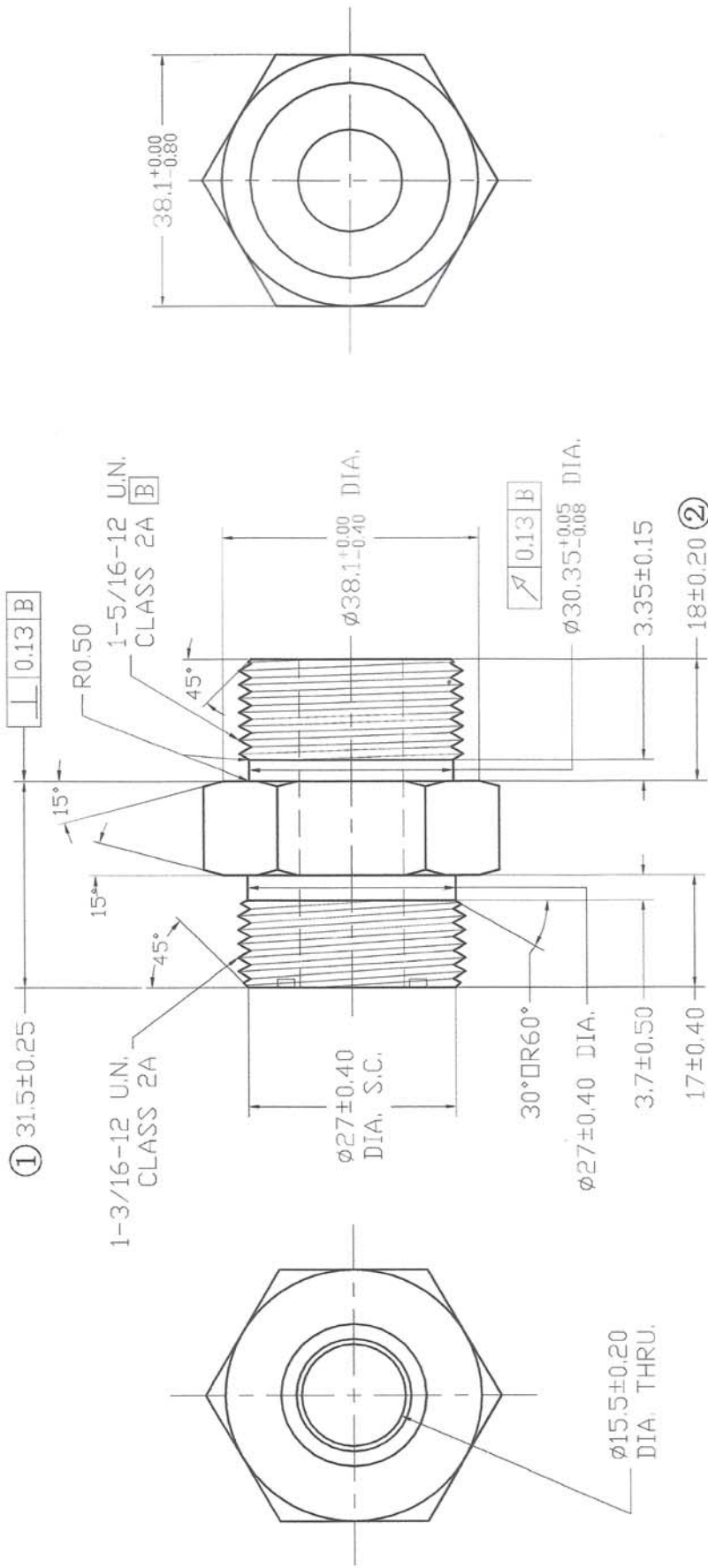

UNLESS SPECIFIED
 ALL DIMENSIONS IN mm,
 MACHINED SURFACES Ra=3.2um,
 ANGLE TOLERANCES ±1°
 Other tolerance except angles,
 in accordance with
 GB/T1804-2000(ISO2768-1)-m
 and GB/T1184-1996(ISO2768-2)-m

其它事项,
 图示尺寸单位为mm,
 未注机加工表面粗糙度 Ra=3.2um,
 未注角度公差 ±1° ,
 其它未注公差 (除角度外) 均按:
 GB/T1804-2000(ISO2768-1)-m 和
 GB/T1184-1996(ISO2768-2)-m

Yuhuan Getal Machinery Co.,Ltd	
PART No 零件名	FS6400-12-16
SCALE:	APPD: LiYonghua
NTS	批准 Zhang
	DATE: 2016.06.25
	日期 27/6/16
	CHK: LJJunBiao
	审核 2016.06.25

MATERIAL Chinese steel 45

FINISH
 Remove all sharp edges, burrs, slivers and swarf, break all edges 0.127-0.254mm.
 ZINC PLATING WITH 12um MICRONS MINIMUM PLATING THICKNESS AND TRIVALENT CHROMATE PASSIVATION
 AND WITHSTAND 96 HRS TO WHITE / 144 HRS TO RED TEST IN SALT SPRAY TEST.

去漆所有毛刺, 铁屑等残留物, 破边倒钝0.127-0.254mm.
 镀锌, 三价铬钝化, 银白色, 盐雾试验96小时无白斑, 144小时无红锈, 镀锌层厚度大于12um.